

DRAFT



Middle School Master Plan Update

March 8, 2023

Perkins&Will

Proposed Improvements

Concept Diagrams – Low Option

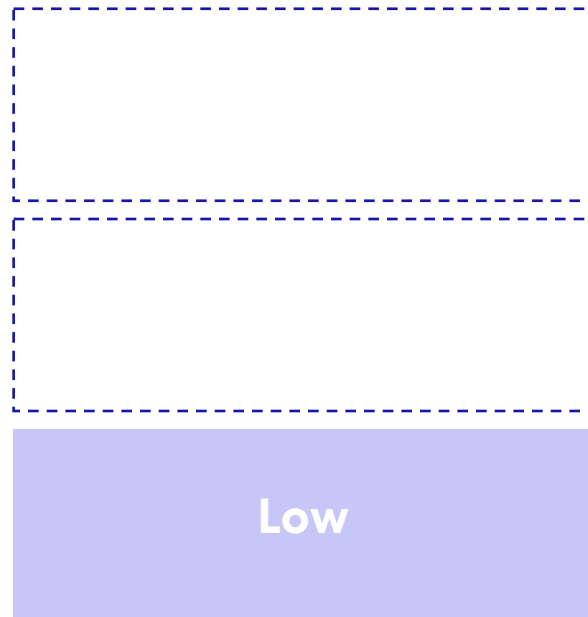

- There is no 'do nothing option'
- Each campus has significant deferred maintenance needs
- Address Health/Life Safety, Maintenance and Physical Plant needs (finishes, maintenance improvements, etc)
- No reconfiguration or upgrade to educational environments

Monroe - Mid

High
Mid
Low

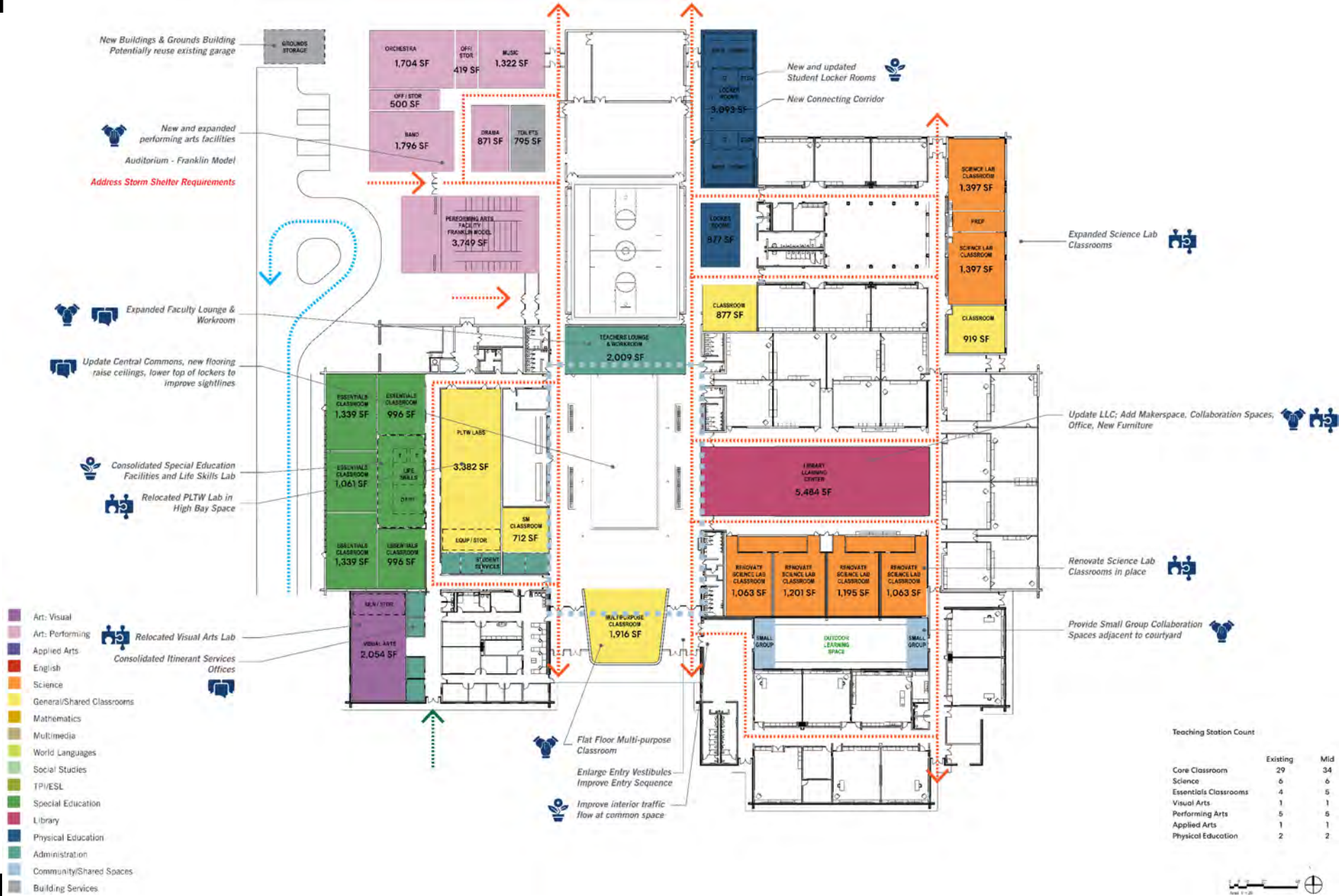

Monroe - High

High
Mid
Low



- Art: Visual
- Art: Performing
- Applied Arts
- English
- Science
- General/Shared Classrooms
- Mathematics
- Multimedia
- World Languages
- Social Studies
- TPI/ESL
- Special Education
- Library
- Physical Education
- Administration
- Community/Shared Spaces
- Building Services

Teaching Station Count
Edison Middle School

	Existing	High
Core Classroom	29	29
Science	6	6
Essentials Classrooms	4	5
Visual Arts	1	1
Performing Arts	5	5
Applied Arts	1	1
Physical Education	2	2

Monroe – Option Evaluation

Improvement Categories	Monroe – Low	Monroe – Mid	Monroe – High
Student Services	--	☾	⊙
Itinerant Services	--	☾	⊙
Classroom Environment	○	☾	☾
Library Learning Centers	--	☾	⊙
Science Lab Classrooms	--	☾	⊙
Small Group/ Collaboration Space	--	☾	⊙
Visual & Performing Arts	--	☾	⊙
Building Look & Feel	☾	☾	☾
Building Systems	--	☾	☾

- No improvement
- Minimally Improved
- ☾ Partially Improved
- ⊙ Fully Improved

Edison – Mid – Level 1



- Art: Visual
- Art: Performing
- Applied Arts
- English
- Science
- General/Shared Classrooms
- Mathematics
- Multimedia
- World Languages
- Social Studies
- TPI/ESL
- Special Education
- Library
- Physical Education
- Administration
- Community/Shared Spaces
- Building Services

Teaching Station Count
Edison Middle School

	Existing	Mid
Core Classroom	24	26
Science	5	5
Special Education SC	3	4
Special Education LG	2	2
Special Education SM	4	4
Visual Arts	1	1
Performing Arts	3	3
Applied Arts	1	1
Physical Education	4	4



Edison – Mid – Level 2

High
Mid
Low



Edison – High – Level 1

High
Mid
Low

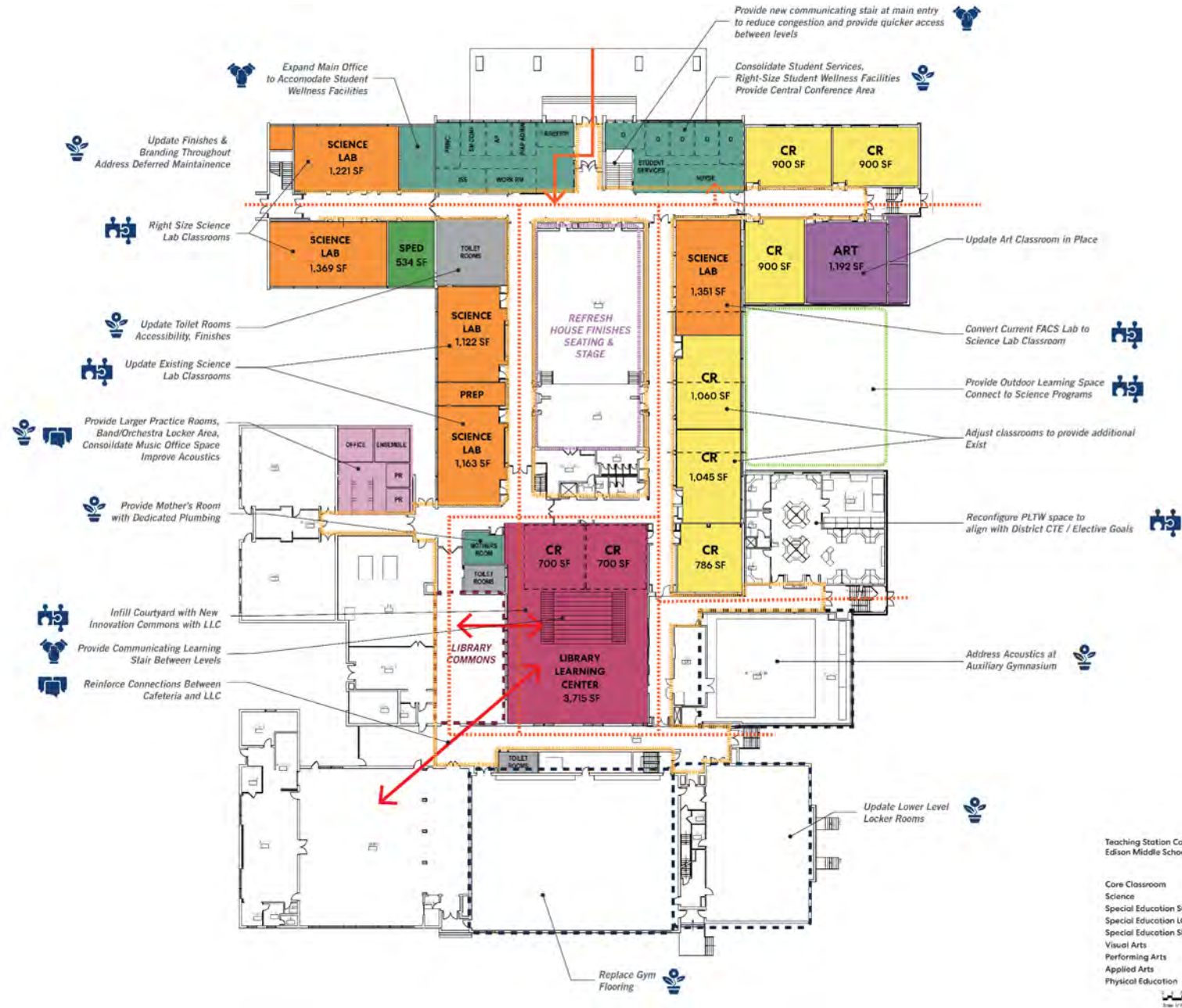

- Art: Visual
- Art: Performing
- Applied Arts
- English
- Science
- General/Shared Classrooms
- Mathematics
- Multimedia
- World Languages
- Social Studies
- TP/ESL
- Special Education
- Library
- Physical Education
- Administration
- Community/Shared Spaces
- Building Services

Teaching Station Count
Edison Middle School

	Existing	High
Core Classroom	24	27
Science	5	5
Special Education SC	3	*
Special Education LG	2	2
Special Education SM	4	4
Visual Arts	1	1
Performing Arts	3	3
Applied Arts	1	1
Physical Education	4	4

Edison – High – Level 2

High
Mid
Low

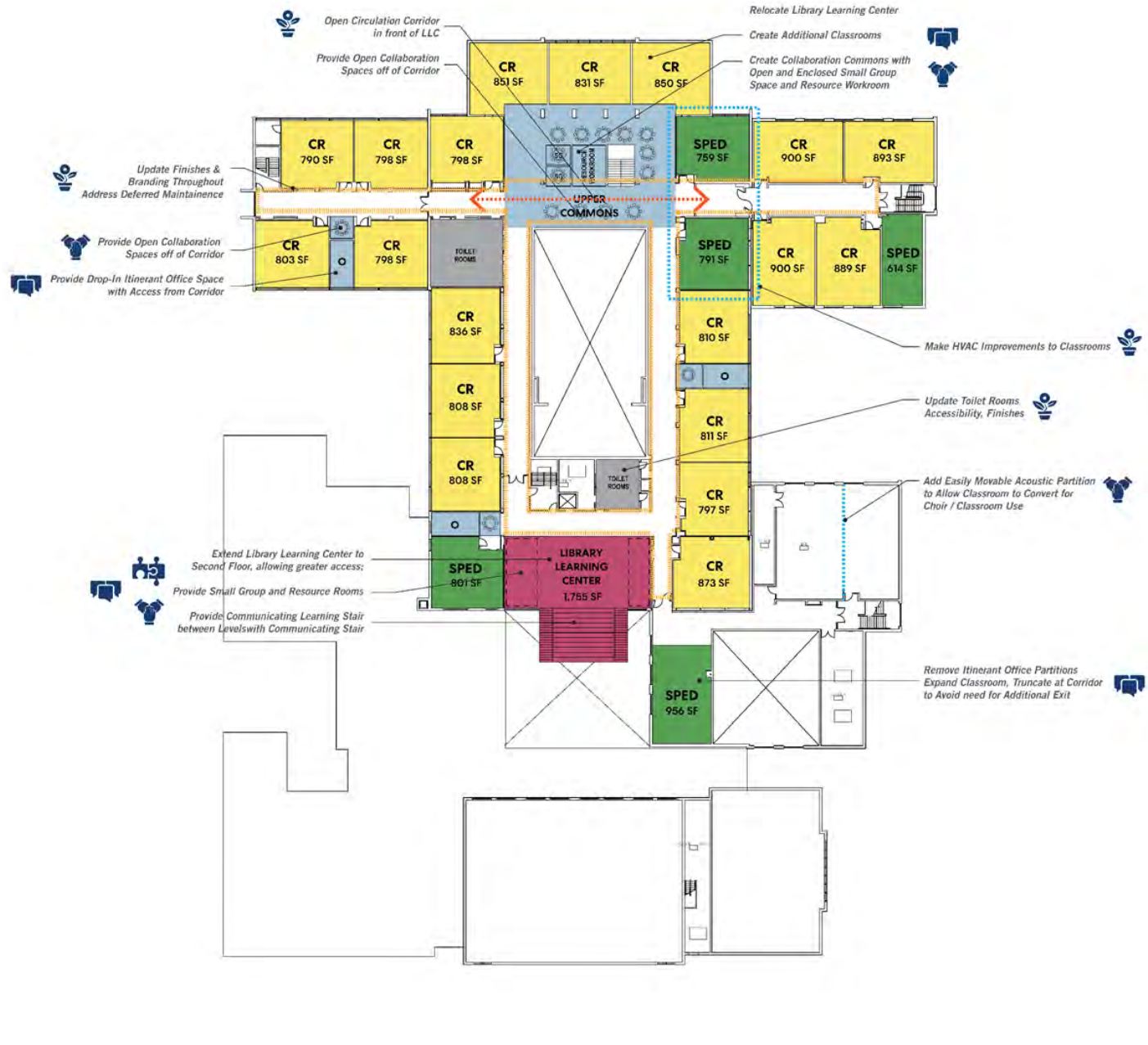

Edison – Option Evaluation

Improvement Categories	Edison – Low	Edison – Mid	Edison – High
Student Services	--	☾	⊙
Itinerant Services	--	☾	⊙
Classroom Environment	○	☾	☾
Library Learning Centers	--	☾	⊙
Science Lab Classrooms	--	☾	⊙
Small Group/ Collaboration Space	--	☾	⊙
Visual & Performing Arts	--	☾	⊙
Building Look & Feel	☾	☾	⊙
Building Systems	--	☾	☾

- No improvement
- Minimal Improvement
- ☾ Partial Improvement
- ⊙ Full Improvement

Franklin Mid Level 1

- High
- Mid
- Low



Franklin Mid Level 2

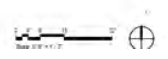
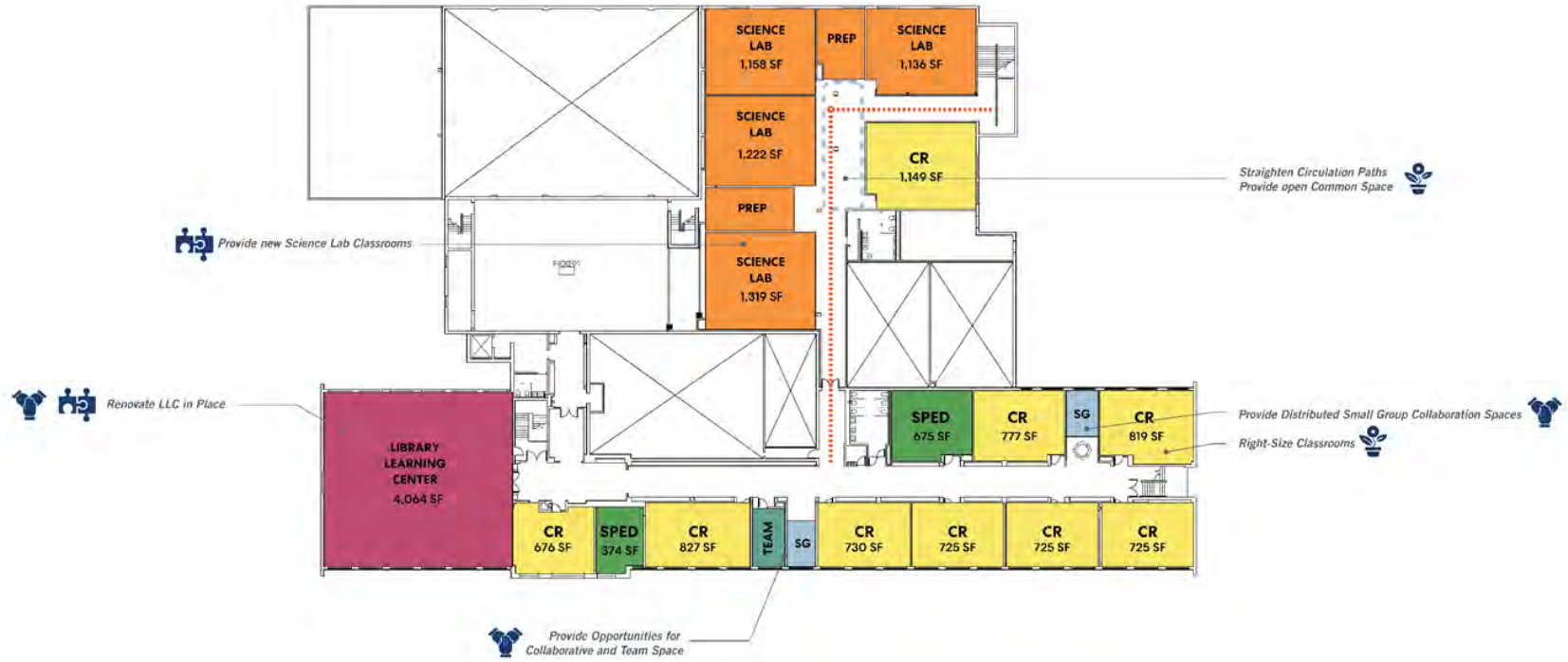

Franklin Mid Lower Level

High
Mid
Low



Franklin High Level 1

- High
- Mid
- Low



Teaching Station Count

	Existing	High
Core Classroom	22	23
Science	6	6
Special Education - Large	2	2
Special Education - Small	2	2
Visual Arts	1	1
Performing Arts	4	4
Applied Arts	1	1
Physical Education	3	3



Franklin High Level 2

High
Mid
Low

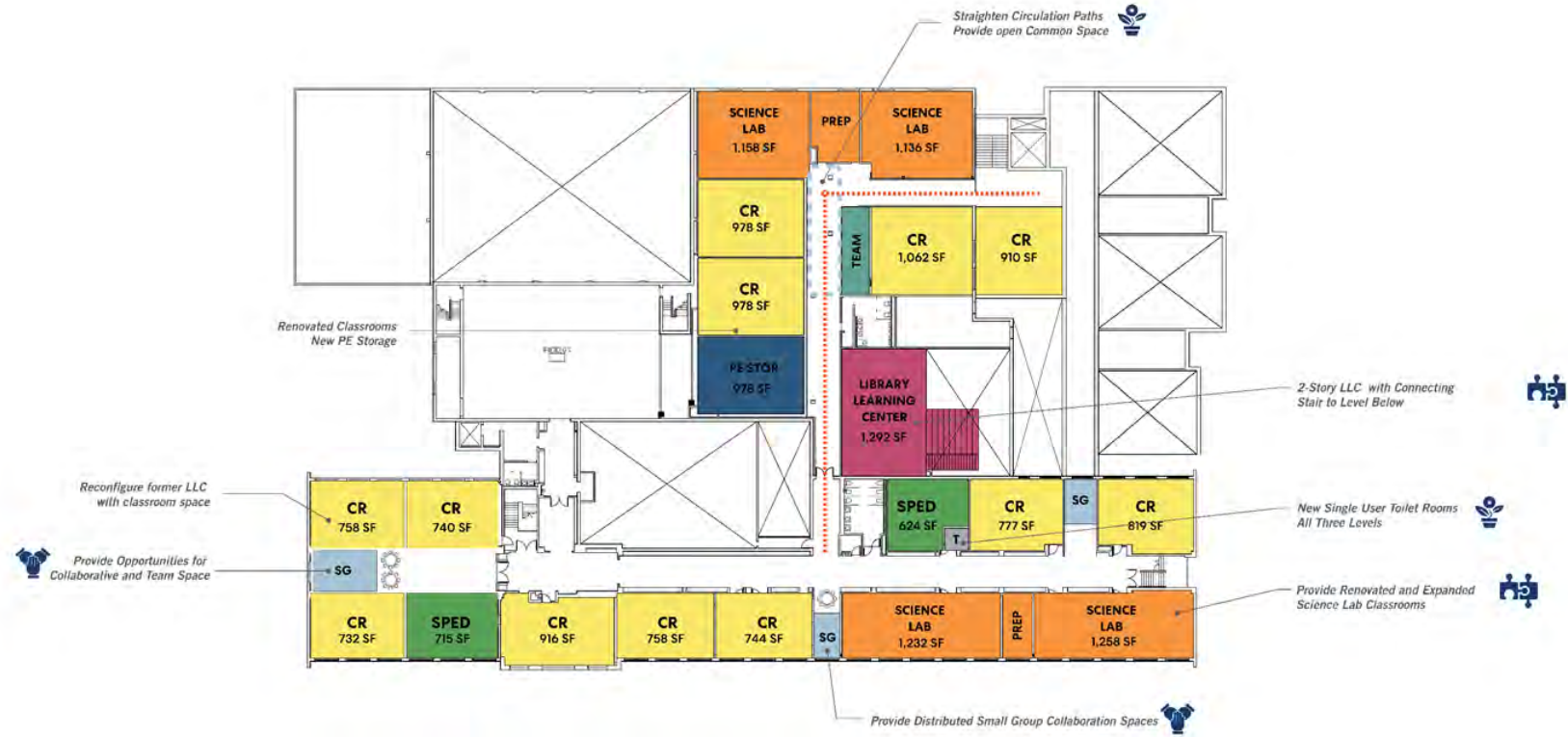

Franklin High Lower Level

High
Mid
Low



Franklin – Option Evaluation

Improvement Categories	Franklin – Low	Franklin – Mid	Franklin – High
Student Services	--	☾	⦿
Itinerant Services	--	☾	⦿
Classroom Environment	○	☾	☾
Library Learning Centers	--	☾	⦿
Science Lab Classrooms	--	☾	⦿
Small Group/ Collaboration Space	--	☾	⦿
Visual & Performing Arts	--	☾	⦿
Building Look & Feel	☾	☾	⦿
Building Systems	--	☾	☾

- No improvement
- Minimally Improved
- ☾ Partially Improved
- ⦿ Fully Improved

Budget Development

Budget Update – Middle School Master Plan



	Low	Mid	High
Monroe	\$12.6M	\$53.9 – 56.7M	\$62.5 – 65.7M
Edison	\$16.3M	\$33.9 – 35.7M	\$42.6 – 44.7M
Franklin	\$12.7M	\$28.8 – 30.2M	\$42.8 – 45.0M
Totals	\$41.6M	\$116.6 – 122.5M	\$147.8 – 155.4M

Notes

1. *Low Option includes Capital Project Budgets taken from Legat Architects 2023 updated assessment and include Condition 1 & 2 Projects for the entire school listed*
2. *The Mid & High Concepts include all work included in the Low Concept; any overlapping scope has been accounted for.*
3. *Budgets are inclusive of total project costs and escalated for construction from 2025-2028 excluding FF&E, hazardous material remediation*
4. *Budget ranges are provided due to uncertainty in market conditions and specificity of scope*